

ANGLE TOOL & STRAIGHT TOOL

ANGLE TOOL

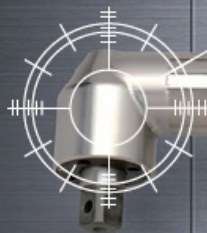

Titanium alloy angle head

The angle head made of titanium featuring light weight and high tensile reduces the operator's load during fastening and provides high durability.

Customization examples



○ Crow foot gear

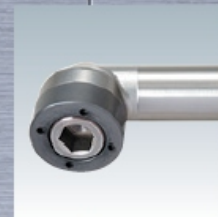

○ Flush socket



○ Long switch lever



○ Short switch lever



EH2-R1020-A
※Full scale

Lightweight and high speed motor

The lightweight motor is used to reduce the burden to the operator from the tool weight during operation. The high speed motor is used to improve the productivity.

STRAIGHT TOOL



Involute spline

Allows various applications including multiple spindle configuration and mounting on an assisting arm. The flanged spindle is provided with the high torque model.

Customization examples

○ Multi-spindle



○ Assisting arm



○ Socket changer



○ Ball plunger



EH2-R1016-S
※Full scale

